

KNOG PARTY COMBO - HOW TO GUIDE -

STARTING OUT:

Default code: 0-0-0-0

1. Remove the black plug

2. While holding the cable ends, firmly hold & rotate the end cap

3. Keep cable fixed during reset

Listen for *click*

DO NOT TWIST ANY DIALS

ACTIVE RESET:

4. Reset is active when endcap is twisted counter-clockwise 90° so the shackle entry lines up with the marker and clicks into place

5. Active reset: set code to the lower marker (blue circle)

NEW CODE:

6. Choose your combination - align with marker (blue circle)

ie. The chosen code for the lock diagram is "4352"

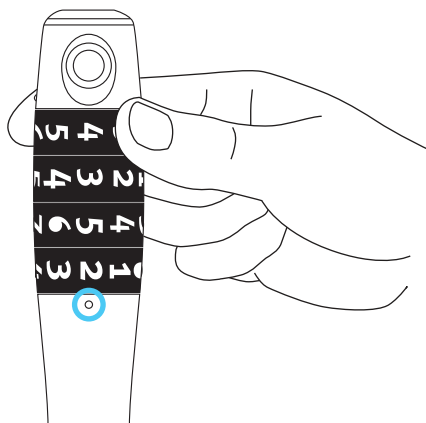
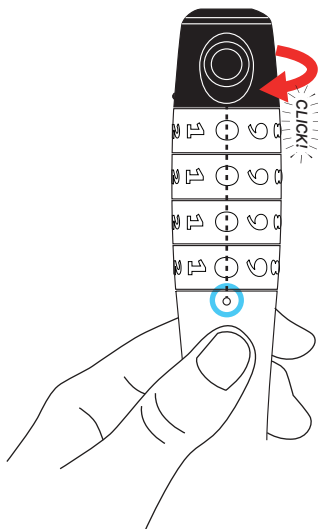
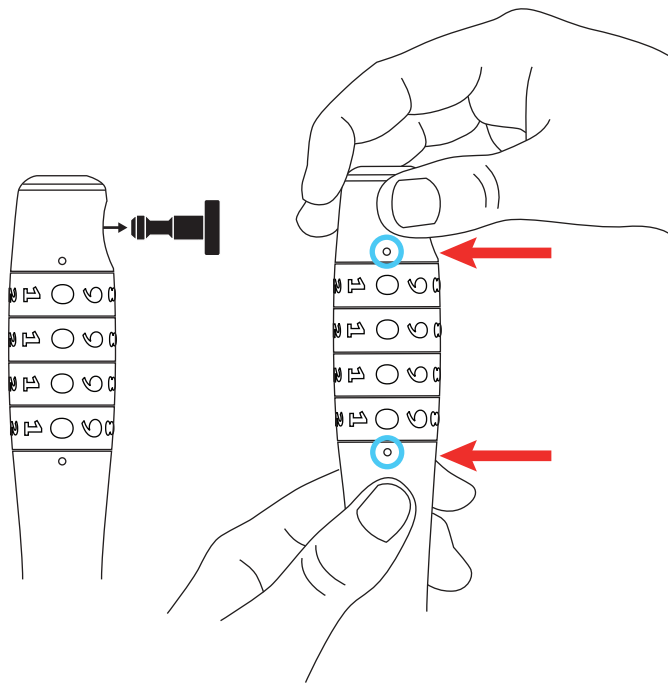

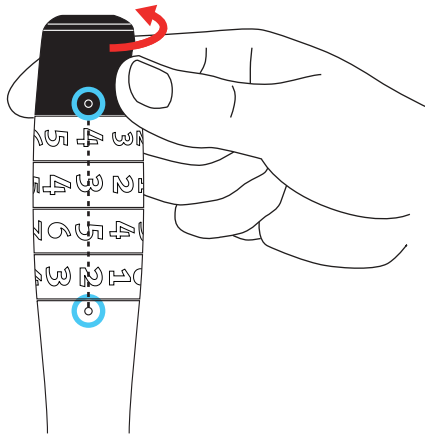

SET CODE:

7. To SET new code return the end cap to its original position by twisting clockwise to align with cable marker

DO NOT rotate dials at this stage

LOCK & LOAD:

8. New code is now ACTIVE.

This means shackle is open to insert cable pin.

9. Insert the cable and rotate dials.
The cable should NOT come loose.

To release the cable enter your unique code

No other combination will release the lock once the code is set

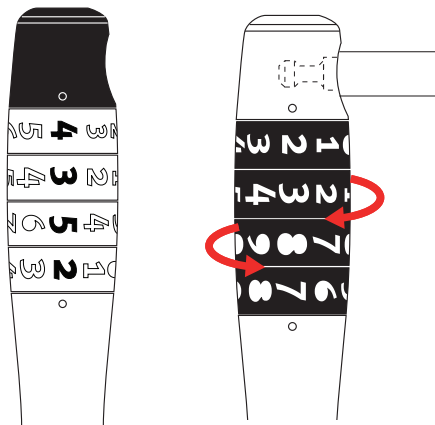

1.

GENERAL NOTES:

1. Please do not purchase any lock if the plug is removed. This means the code may have been tampered with!

2. When travelling with your combo lock, avoid leaving it unlocked

3. Keep your combination stored safely

