



Light Source:	2 x Cree XM-L2 LEDs
Light Output:	1000 measured lumens 1400 generated lumens
Beam:	2 x spot (+/- 9°) FWHM: 18°
Mounting:	QR bayonet style handlebar or helmet mount
Battery:	ES Integrated Li-Ion ES battery with fuel gauge Nominal capacity 3200mAh Minimum capacity 3100mAh
Charge Time:	3.5hrs
Weight:	252g
Power Levels:	6 (two sequences of 3), including flash
Burn Time:	1:00 hr - 30:00 hrs



HLNR2ISTUK - Standard UK
HLNR2ISTEU - Standard EU

INSTRUCTION MANUAL

IMPORTANT INFORMATION

We strongly advise you read the following recommendations in order to prevent injury or damage to the lighting system.

NOTE: The battery is supplied only half charged. Please ensure that you fully charge the battery before first use (see 'Battery Charging' section).



WARNING

- This lighting system will withstand harsh wet weather conditions. However, it is not designed to be submersed in water. If the light is fitted to a bike, please ensure that the light unit is removed from the bike before washing - particularly if using a high pressure jet wash.
- Do not look directly at the beam, permanent eye damage could result. Consider other people when mounting the light on the head to avoid dazzling them.
- Keep this light away from children.
- This light unit can get hot when in use in maximum power mode. This is normal and should not be mistaken as a malfunction. Please use with caution.
- Unlike unregulated LED lighting systems, this light unit will shut down suddenly after a period of time in low battery mode without any dimming of the light. Please bear this in mind when using at night.
- Only use the battery charger that is supplied with the lighting system. Use of any other battery charger may result in explosion and serious injury.
- Do not short-circuit the charging terminals. This can cause the battery to overheat and could result in fire or explosion.
- The battery charger is designed for indoor use only and should not come into contact with water.
- The battery charger contains dangerous voltages and the cover should not be removed. Any attempt to open the charger will invalidate the warranty.
- This light unit conforms to the requirements of EC directive 2004/108/EC for electromagnetic compatibility.

DISPOSAL

When the equipment has reached the end of its life please dispose of the components in accordance with your local waste regulations. Lamps and batteries should be recycled where possible and not disposed of with regular waste.



Li-Ion

CONTENTS

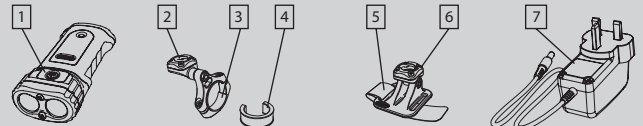

- | | |
|-------------------------------|-----------------------------|
| 1. R2i lamp unit | 5. Helmet mount |
| 2. QR bayonet handlebar clamp | 6. QR bayonet mount adapter |
| 3. 31.8 handlebar shim | 7. Battery charger |
| 4. 25.4 handlebar spacer | |

LI-ION ES BATTERY PACK

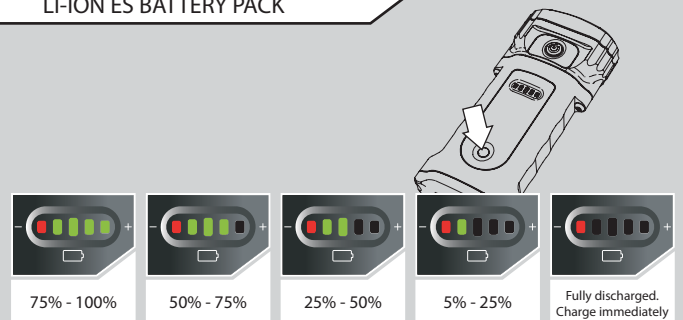

The integrated ES (Energy Status) battery features a 5 stage fuel gauge. Press and hold the 'TEST' button to activate the LED display. This gives a visual indication of the remaining capacity within the battery cells.

MOUNTING INSTRUCTIONS

Handlebar mount

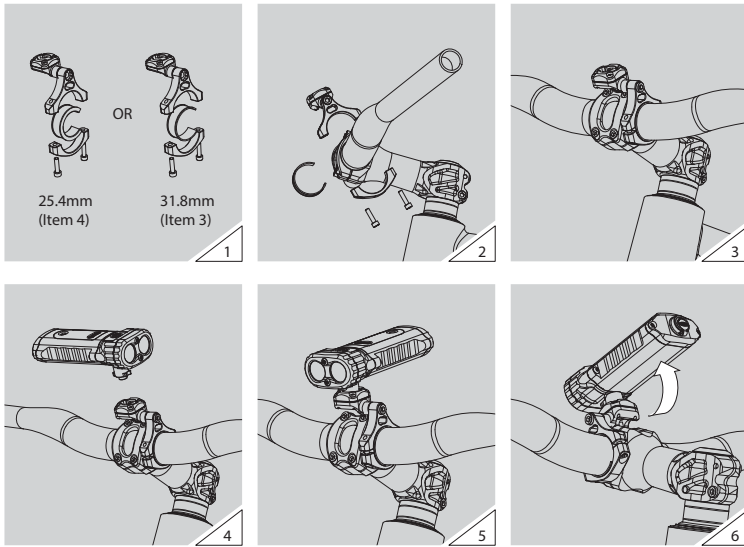

Helmet mount

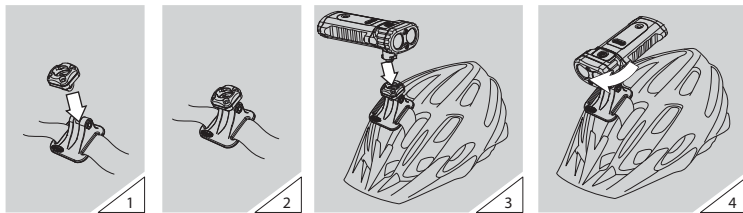

BATTERY CHARGING

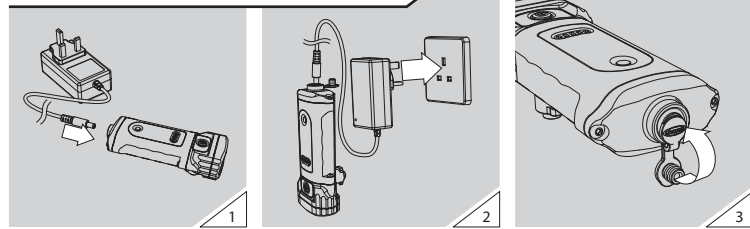

DANGER: Only use the battery charger that is supplied with the lighting system. Use of any other battery charger may result in explosion and serious injury. The battery charger is designed for indoor use only and should not come into contact with water. The mains socket should be easily accessible. In the event of any operational error the plug should be immediately removed from the mains supply. The battery charger contains dangerous voltages and the cover should not be removed. Any attempt to open the charger will invalidate the warranty.

NOTE: Never remove the charge port cover while the lamp unit is wet to avoid any ingress of moisture. Thoroughly dry the unit before attempting to charge the battery.

The rechargeable Li-Ion battery cells are supplied with a small charge for testing purposes only. Therefore, please ensure that the battery is fully charged before first use. To correctly charge the battery pack, ensure these steps are followed in order:

- Plug the battery charger into the charging socket of the lamp unit (1).
- Once the battery charger is connected to the lamp unit it can then be plugged into the mains power supply (2). The charger's LED indicator will light up red during the charging process.
- When charging is complete, the charger's LED indicator will turn green. Disconnect the battery charger from the mains power supply before unplugging the charger from the lamp unit.
- Always replace the rubber cover back into the charging socket once charging has completed (3).

NOTE: If you attempt to place the battery pack on charge after only a short period of use (ie. with the remaining capacity at around 75% or higher, with four indicators lit on the LED display), you may notice that the battery pack will not begin charging. This is not a fault. It is simply due to the software communication between the battery pack and charger. The charger is looking for a battery voltage of lower than 8v before it will begin the charge process.

If this happens, simply connect the battery pack to the lamp for a short while to further discharge the battery pack. It will then charge successfully.

Charge Times: A fully discharged battery should take approx 3.5 hours to fully recharge.

STORAGE AND TRANSPORTATION

In order to prevent any malfunction within your Li-Ion battery and to preserve the capacity as much as possible, there are a number of procedures which must be considered when storing your R2i for long periods while not in use (ie. over the summer months).

Storage and transportation: When storing or transporting the lamp unit in a container (or bag) be careful that the power button is not accidentally pressed. Unintentional powering up will discharge the battery cells and could cause the lamp unit to get hot if it is operated in an environment with no air flow, so care must be taken not to store the unit near to materials that are sensitive to heat. The lamp does include intelligent thermal management which will restrict the power if it detects that the unit is getting too hot but care must still be taken to avoid the risk of overheating.

Storage Temperature: The lamp should be stored within the temperature range of -20°C to 25°C in order to preserve cell capacity. Ideally in a cool, dry room such as a cellar or garage.

Over discharging: As with most battery cells, Li-Ion cells may discharge if they are not used for a long time. In order to prevent over-discharging fully charge the battery before storing (see 'Battery Charging' section). Also, charge the battery periodically (ie. once every 3-4 weeks) to maintain the voltage between 6.8V to 7.6V. Over discharging may cause loss of cell performance, or damage battery function.

If these few procedures are followed correctly, you can be sure that when the dark nights creep back in your R2i will be fit and raring to go!

WARRANTY

All Hope Technology lighting systems are covered for one year from original date of purchase against manufacturer defects in material and workmanship. Proof of purchase is required. Product must be returned to Hope Technology to process any warranty claim. This warranty does not cover any damage caused through mis-use or failing to comply with the recommendations given in this manual. This warranty does not affect your statutory rights.

OPERATION OF THE LAMP

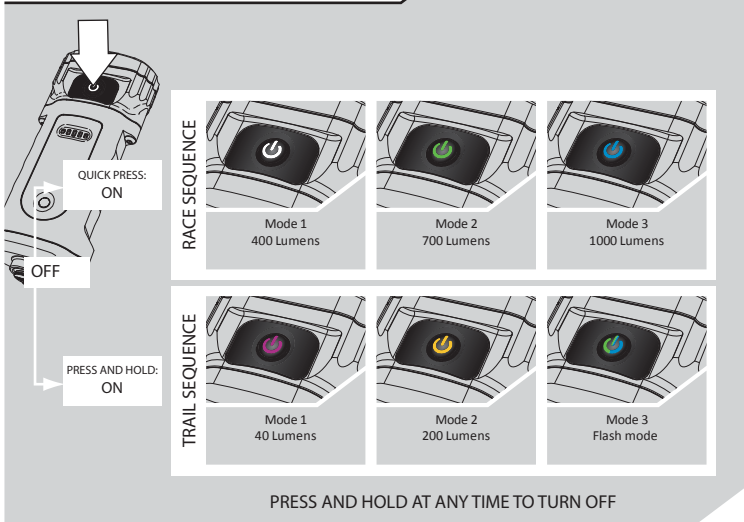

Note:

The R2i lamp includes an 'energy preserve' feature whereby the power will automatically drop down from mode 3 to mode 2 towards the end of the battery discharge cycle (i.e. after approximately 1 hour in mode 3 depending on conditions). The switch illumination will change from blue to green at this point. This is to prolong the remaining energy within the battery. If you attempt to re-select mode 3 during the energy preserve period the lamp will immediately fade back down to mode 2 and block the selection of mode 3 in order to maximise the remaining battery life. Operation of the lamp then continues with only modes 1 and 2 remaining active with each subsequent press of the power button. Mode 3 is no longer selectable. This is a deliberate characteristic of the drive circuit and should not be interpreted as a malfunction.

The R2i also features a low battery warning mode. When the battery is almost at the end of its discharge cycle the lamp will drop down into low power mode, the switch will illuminate red, and the lamp will flash twice every 30 seconds to warn you that you are running low on battery life. Once the lamp unit has dropped into low battery mode, no other modes are selectable. Pressing the power button will only turn the lamp off or on.

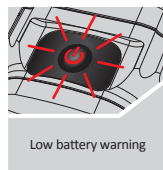

Low battery warning

*Although every effort is made to state accurate burn times, battery life is dependant on various factors and environmental conditions. Therefore, actual burn times may vary from those shown.